





MobileGo

MobileGo Plus

FILTERS	CODE	
MobileGo Hepa Filter Cassette	PLY-MG-FILTERHEPA	
MobileGo Pre-Filter Cassette	PLY-MOBILEGO-G4	

MOBILEGO

COMPACT WELDING FUME EXTRACTOR



MobileGo is a compact mobile welding fume extractor with arm. It is designed as an entry level extractor for welding processes that produce low levels of fume. This unit can easily be moved around the workshop to extract the fumes where needed. The MobileGo is fitted with a pre-filter made from polyester and a HEPA (main) filter made from glass fibre. MobileGo has a W3 marking (according to ISO15012-1:2013) and can be used in steel and stainless steel applications.

- Suitable for light welding activities, stainless steel welding, auto repair shops, agricultural sectors and TIG welding.
- Effective protection against exposure to welding fume.
- Easy to manoeuvre.
- Includes shut-off damper.
- Two stage filter for longer filter life (pre-filter & HEPA filter).
- Replaceable Filters.
- 360° ring handle allows ease of reach and access.
- Hood collar fitted with safety mesh.
- Comes with a 5m lead with plug.
- Audible alarm indicates filter replacement required.

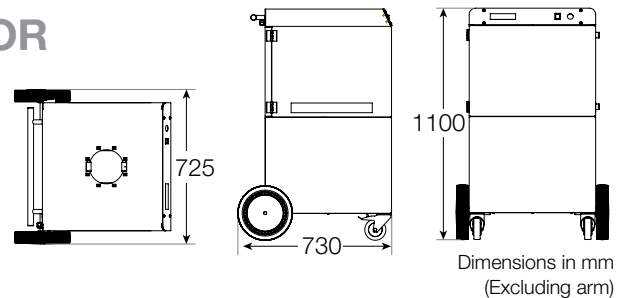

MOBILEGO

- Fitted with EconomyArm extraction arm which has a reach of 2m-4m.
- Filter capacity of: 15m².
- Recommended when one coil of solid welding wire or 7.5kg of welding electrodes are used per month.

MOBILEGO PLUS

- Fitted with KUA extraction arm which has a reach of 2m-4m.
- Filter capacity: 26m².
- Recommended when 2 coils of solid wire or 15kg of welding electrodes are used per month.

PRODUCT CODE	PLY-MOBILEGO-P-3M	PLY-MOBILEGO-3M
Description	MobileGo Plus	MobileGo
Max. Working Radius	3m	3m
Tube Diameter	160mm	160mm
Hood Diameter	300mm	300mm
Max Extraction Air Flow m ³ /hr	850	850
Weight (kg)	Excluding Arm	85.5
	Arm Only	15.5
Weight (kg)	Excluding Arm	84
Weight (kg)	Arm Only	13
Noise Level	67dB(A)	67dB(A)
Volts	230/1ph/50Hz	230/1ph/50Hz